

Aluminium
+ glass
structure

Design
Supply
Installation

adexsiuk

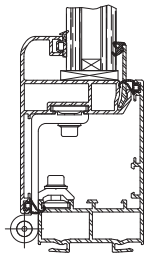

Standard profile

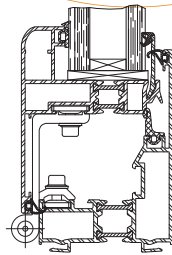

Profile with thermal bridge



The EXUBAIE is a facade casement for smoke and air ventilation, equipped with components necessary for its opening.

DESCRIPTION

- EXUBAIE is a NSHEV (Natural Smoke and Heat Exhaust Ventilators) integrating its own mechanisms for installation on glazed structure.
- For wall installation: bottom/top/side hung outwards or inwards opening.
- The EXUBAIE profiles can be with or without thermal broken profile. The different adaptations available allow an easy installation on concrete, wood or on curtain wall.
- All finishes available: In any RAL paint or anodised finish.

REGULATION

- EXUBAIE is a NSHEV (Natural Smoke and Heat Exhaust Ventilators) conforms to EN 12101-2 and NFS 61 937-1.

PROFILES

- Standard (STD).
- Thermally broken profile (RPT).
- Adaptation on curtain wall.

PERFORMANCES

- NSHEV (Natural Smoke and Heat Exhaust Ventilators) certified NF EN 12101-2 and NFS 61 937-1.
- Classification Air/Water/wind (A 3, EE, UE) – new trials according to current European standards.
- Reliability Tests: Re 1,000 et Re 10,000.
- Aerodynamic value: Cv from 0,5 up to 0,6 in accordance with size and opening angle.
- Ug: from 1,9 up to 4 W m²/°K for opaque thermal infills.
Ug: from 2,1 up to 5,7 W m²/°K for glass infill

* Test reports on demand.

**A clear solution
for smoke control
and ventilation.**



The Business Centre, Cardiff House,
Cardiff Road, Vale of Glamorgan, CF63 2AW



(+44) 0845 0840 555



(+44) 0845 0840 556



info@adexsiuk.com

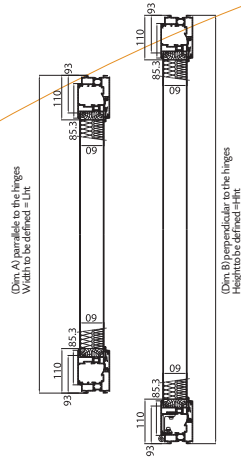

Acoustic infill

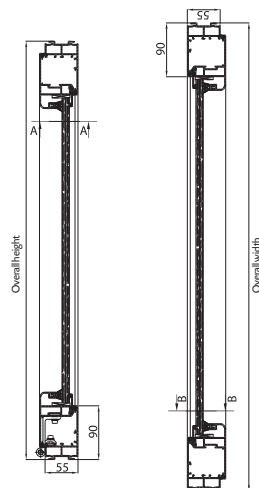

Glass infill

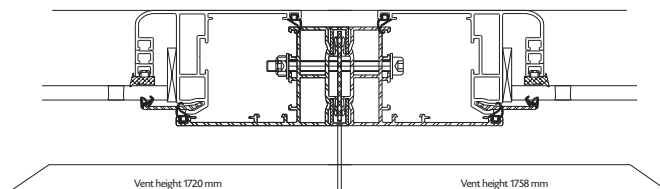

Assembly of 2 frames

DIMENSIONS

Dimensions mini and maxi, in width and length overall:

- Mini: 500 x 500
- Maxi: 1,600 x 1,600 or 2,400 x 1,200
- Weight of opening leaf: 60 kg maxi.
- For side hung ventilators, maximum dimensions are limited to 900 x 1,800 or 800 x 2,400
- Weight of opening leaf: 60 kg.

INFILL

- Thickness mini acceptable: 6 mm with standard profile and 10 mm with thermally broken profile, Thickness maxi acceptable: 26 mm with standard profile and to 38 mm with thermally broken profile.

Filling available:

- Polycarbonate (PCA): 10 mm, 16 mm, 32 mm (light, opalescent or bronze).
- Insulated glass: standard, with reinforced insulation, with solar control...
- Thermal insulated infill: opaque, insulated aluminium (2 sheets of aluminium 15/10° + 30 mm insulation).
- Acoustic infill also available.

TYPES OF CONTROLS

- Electric.
- Pneumatic.
- Mechanical

Remote control:

- Basic release or opening and closing.

Mode:

- Power on mode
- Fail safe open

OPTIONS

- Thermal releaser.
- Safety switches open/close (Security option).

INSTALLATION

- For vertical wall installation ($\pm 10^\circ$). Consult us.
- Specific adaptation profiles, accessories available.